

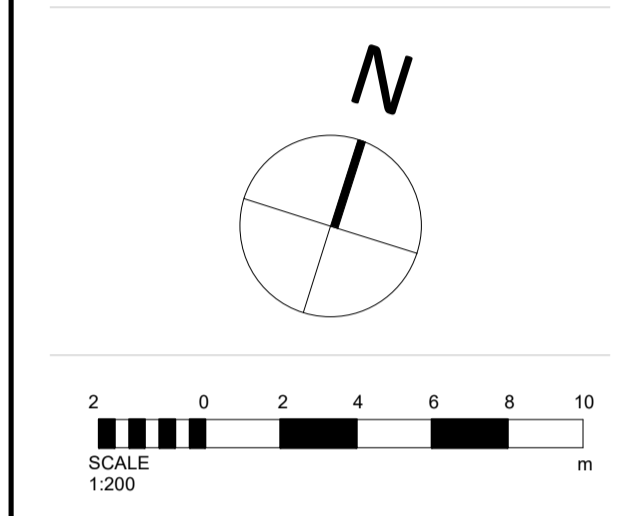

Notes:
 - Do not scale from this drawing. Use figured dimensions in all cases.
 - Verify dimensions on site and report any discrepancies to the Architect immediately.
 - This drawing is to be read in conjunction with the Architect's Specification.
 - © This drawing is copyright and may only be reproduced with the Architect's permission.

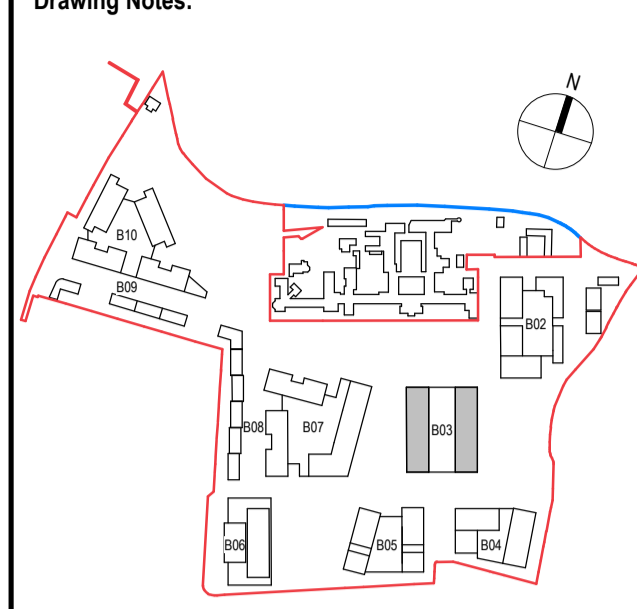

- Planning Legend**
- Site Boundary —
 - Residential Entrance ▲
 - Service Entrance ▲
 - 1B2P ■
 - 2B3P ■
 - 2B4P ■
 - 3B5P ■
 - Amenity ■
 - Restaurant ■
 - Retail ■

Rev.	Date	Drwn	Details of Issue / Revision
P3S-1	Sept 2024	KP	Part 10 Planning Application
			Issues & Revisions

Darity Mills,
 Darity Road
 Dublin 6,
 D06 Y0E3
 T: +353 (0)1 498 7000
 W: www.reddyarchitecture.com
 E: info@reddyarchitecture.com

Applicant Details:
 Dún Laoghaire-Rathdown County Council
Agent Details:
 Land Development Agency

Project Details:
 Proposed Part 10 Residential Development,
 Dundrum Central Development,
 Dundrum Road,
 Dublin 14
Drawing Title:
 Block 03, Ground Floor, GA Plan

Job No.	Sheet Size	Scale @A1:
P19-233D	A1_Landscape	1 : 200
Issue Date:	Drawn By:	Reviewed By:
Sept 2024	K. Potocka	R. Quinn

Status	Purpose of Issue
P3	Part 10 Planning Application
Project - System - Spatial Zone - Level - Type - Originator - Role - Number	Revision
DCD-02-B03-L00-DR-AU-AR-1300	P3S-1